



# SX4

*Four Axle Side Dump Trailer*



46' to 50' frame lengths ◀ Stockpile or windrow ▶ Watertight; no leaks ▶ Low load height

800-779-8099 • 712-546-4409 • [sidedump.com](http://sidedump.com)

Four Axle Side Dump  
**SX4**



# SX4

## Four Axle Side Dump Trailer

### Model SX4-4636 SmithCo Side Dump Trailer

Specs shown are for 46' frame length; other configurations available.

<b>Frame Length</b>	46'
<b>Tub Length</b>	36'
<b>Width</b>	102'
<b>Height</b>	8' 7" at Tub side, 9' 10" at Center
<b>Tub Construction</b>	1/4" Thick, AR400 Steel (or equivalent) 3/16" Thick, AR400 Steel (or equivalent) is optional External Column Supports, No Center Tub Divider
<b>Frame Construction</b>	80/100 KSI, Fabricated Steel I-Beam
<b>Kingpin</b>	2" Kingpin, 18" Setting, Replaceable Type
<b>Landing Gear</b>	Two Speed, Non-Load Bearing
<b>Bumper</b>	Push Bar Type, Bolt-On
<b>Cylinders</b>	3500 PSI, 5" bore
<b>Hinges</b>	Self-Aligning, Spherical Bearing Type (greaseable)
<b>Suspension</b>	Air Ride Suspension Standard; Spring Ride Available
<b>Axles</b>	(4) 25,000# capacity
<b>Hubs</b>	10 Hole, Hub Piloted
<b>ABS</b>	2S1M Anti-Lock Brake System
<b>Drums</b>	Outboard Mount, Cast Steel
<b>Wheels</b>	Steel Disc, 8.25 x 22.5 (16)
<b>Tires</b>	11 R 22.5 G Radial Tires (16)
<b>Brakes</b>	16 1/2" x 7"
<b>Fenders</b>	Front & Rear, 1/4" Synthetic, 7 Degree Slope
<b>Lights</b>	12 Volt LED ICC w/Sealed Harness
<b>Mud Flap</b>	(2) Polyline Anti-Spray Splash Guard w/SmithCo name
<b>Paint</b>	Polyurethane, any combination of gray, white or black Special colors available upon request
<b>Min. Tractor Hydraulic Reqs.</b>	25-30 GPM, 2,600-2,800 PSI, 10 Gallon Reservoir

### SX Series Tub Capacities

	34' Tub	36' Tub
<b>Waterfull</b>	23 cu yd	24 cu yd
<b>Heaped</b>	31 cu yd	32 cu yd

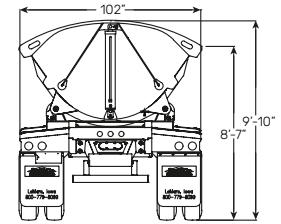

### Model SX4-4636

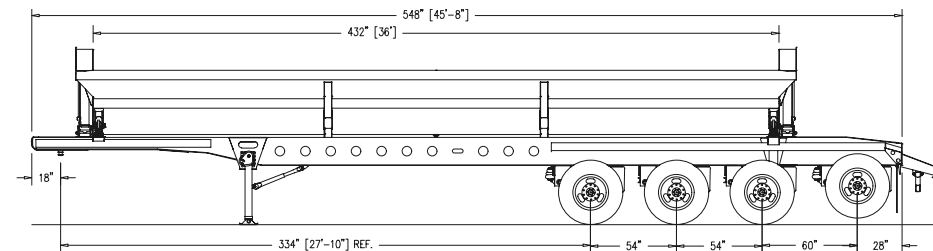

### Model SX4-4936

